

- a. SLOT IN FLOOR FOR ELECTRICAL SERVICE ENTRANCE TO C.B. PANEL.
 b. 4" X 5/16" STEEL FLAT BAR WITH 3/4" ANCHOR BOLT HOLES. ANCHOR BOOTH AFTER FINAL LOCATION. ANCHOR BOLTS NOT INCLUDED.
 c. OUTER EDGE OF BOOTH.
 d. SUGGESTED MINIMUM FOUNDATION/SLAB.
- GENERAL SITE INSTALLED ITEMS PROVIDED BY OTHERS**
1. PROVIDE 120/240V, 1Ø-3 WIRE SERVICE WITH GROUND.
 2. CONCRETE FOUNDATION/SLAB MINIMUM 6" DEEP 3,000 PSI MINIMUM (28 DAY ACI 318) REINFORCED. THE FOUNDATION/SLAB SHOULD BE MINIMUM OF 12" WIDER THAN THE ROOF LINE DIMENSIONS TO ALLOW A 6" CONCRETE BORDER ON EACH SIDE OF THE BUILDING ROOF LINE.
 3. ADEQUATE SIZE DRILLED ANCHOR BOLTS. SUGGESTED SIZE 5/8" X 4-1/2" POWER FASTENERS "POWER STUD" CATALOG #7432.

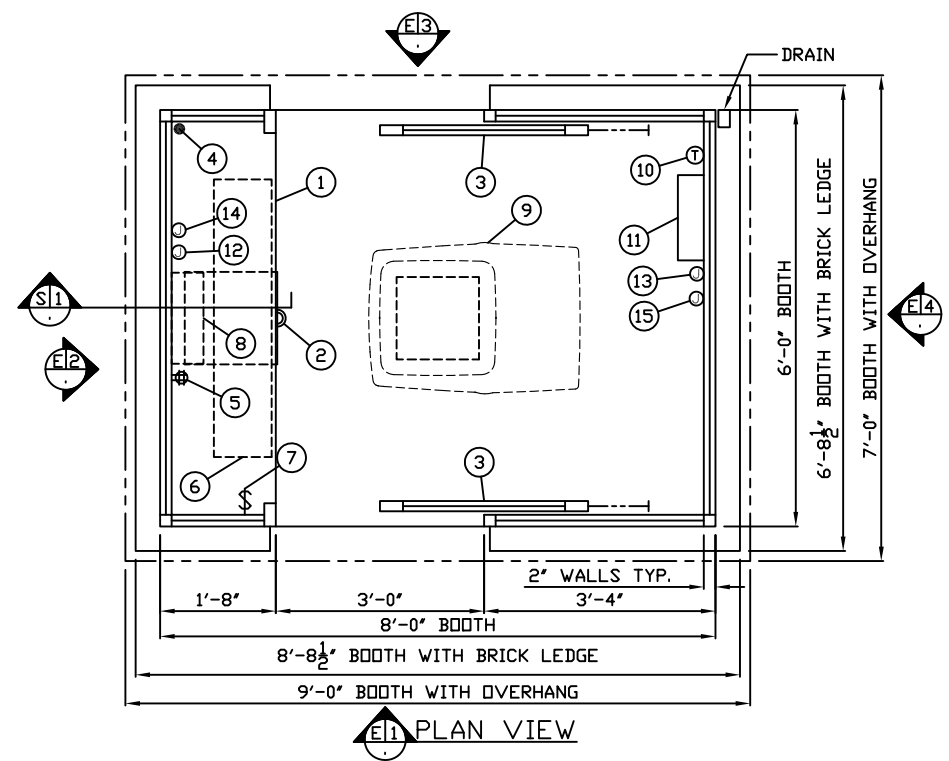
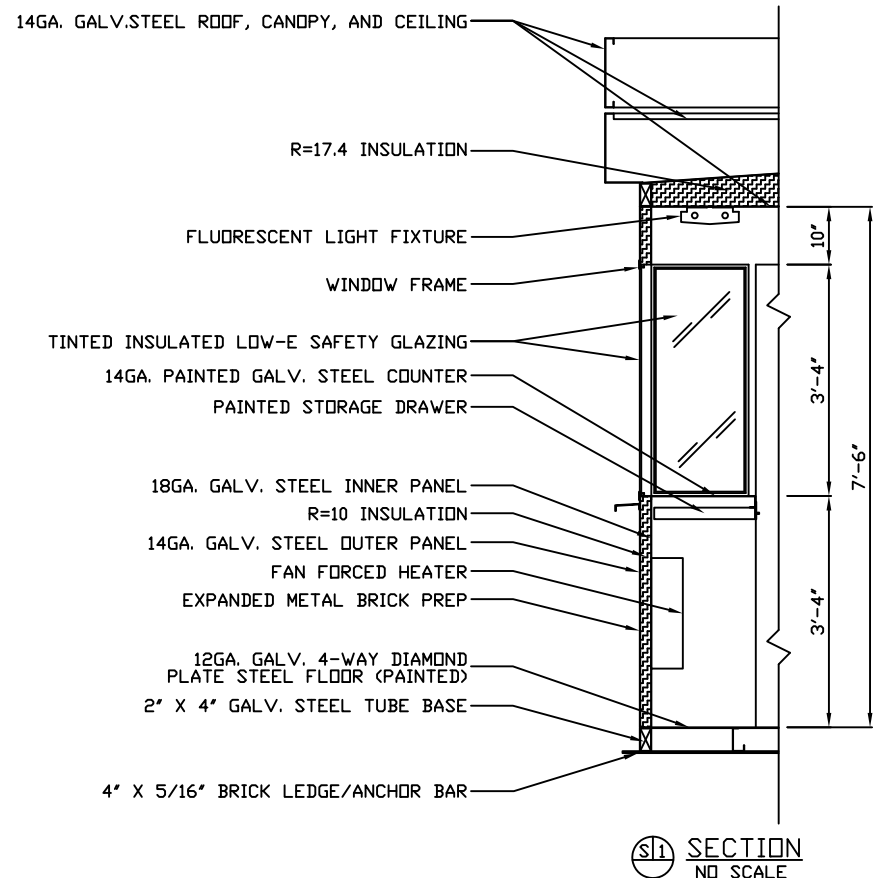

1. COUNTER- 20" DEEP PAINTED GALV. STEEL MOUNTED AT SILL.
2. STORAGE DRAWER MOUNTED BELOW COUNTER.
3. DOOR- 36" WIDE, SLIDING STEEL WITH VERTICAL SLIDING TRANSACTION WINDOW WITH SPRING BOLTS, WEATHER-STRIPPING, BALL BEARING HANGERS, HEAVY DUTY TRACK, HOOK BOLT LOCK, AND HARDWARE. 2-REQ'D.
4. 2" DIAMETER HOLE IN COUNTER FOR DROP CORDS.
5. QUADPLEX OUTLET MOUNTED ABOVE COUNTER.
6. FLUORESCENT LIGHT- 2 LAMP 32 WATT LAMP FIXTURE WITH ACRYLIC LENS & WALL SWITCH.
7. SWITCH FOR INTERIOR LIGHT.
8. HEATER- 240V/4,000 WATT FAN FORCED HEATER WITH INTEGRAL THERMOSTAT CONTROL.
9. AIR CONDITIONER- 120V/15,000 BTU ROOF MOUNTED WITH WALL MOUNTED THERMOSTAT CONTROL.
10. THERMOSTAT FOR AIR CONDITIONER.
11. CIRCUIT BREAKER PANEL- SQUARE-D #QD112M100, 120/240V_{ac}, 12 SPACE, 1Ø-3 WIRE WITH GROUND BAR AND 100 AMP MAIN BREAKER INCLUDED.
12. JUNCTION BOX LOCATED BELOW COUNTER WITH 1/2" RACEWAY TO JUNCTION BOX ITEM #13.
13. 2" X 4" JUNCTION BOX LOCATED NEAR FLOOR SLOT FOR PHONE WIRING.
14. JUNCTION BOX LOCATED BELOW COUNTER WITH 1/2" RACEWAY TO JUNCTION BOX ITEM #15.
15. 2" X 4" JUNCTION BOX LOCATED NEAR FLOOR SLOT FOR DATA WIRING.

NOTE: PAR-KUT BOOTHS ARE OF SINGLE UNIT WELDED STEEL CONSTRUCTION, FACTORY ASSEMBLED AND DELIVERED SET UP. FAILURE TO SECURELY ANCHOR BOOTH MAY RESULT IN OVERTURNING OF UNIT AND SERIOUS INJURY TO OCCUPANT.

- A. GLAZING- TINTED INSULATED LOW-E TEMPERED SAFETY GLAZING SET IN ANODIZED ALUMINUM IN ALL FIXED WINDOWS.
- B. PAINT- FINISH SHALL BE SINGLE COLOR OF CHOICE, IMRON POLYURETHANE HIGH GLOSS INDUSTRIAL COATING. SHALL BE APPLIED TO ALL EXPOSED METAL SURFACES. THIS EXCLUDES FLOOR, ROOF SURFACE, ANODIZED ALUMINUM WINDOW FRAMES AND ANY STAINLESS STEEL COMPONENTS (IF USED).
- C. ELECTRICAL- ALL WIRING BY PAR-KUT TO BE #12(MIN) STRANDED COPPER, THHN ENCLOSED IN 1/2"(MIN) E.M.T. PER NATIONAL ELECTRIC CODE. FITTINGS, FIXTURES, AND DEVICES ARE UL. LABELED. ALL WIRING TO TERMINATE AT C.B. PANEL. ALL CIRCUITS HAVE GREEN GROUND WIRE.
- D. BOOTH WILL HAVE A 6" CANOPY OVERHANG ON ALL SIDES.
- E. TWO LIFTING RING(S) ARE PROVIDED ON ROOF.
- F. NO ON SITE WORK BY PAR-KUT.
- G. NO MASONRY SUPPLIES, BRICK OR MASONRY WORK BY PAR-KUT.

GENERAL NOTES	
BOOTH PAINT COLOR:	DC 1046 DESERT SAND
GLAZING TINT COLOR:	GRAY
PREP FOR BRICK	

NOTE: THIS PRINT AND DESIGN ARE THE PROPERTY OF PAR-KUT INTERNATIONAL, INC. IT MUST NOT BE REPRODUCED IN ANY MANNER, NOR SHALL IT BE SUBMITTED TO OUTSIDE PARTIES FOR EXAMINATION WITHOUT OUR CONSENT. IT SHALL BE USED ONLY AS A MEANS OF REFERENCE TO WORK DESIGNED AND FURNISHED BY PAR-KUT. PAR-KUT RESERVES THE RIGHT TO MAKE CHANGES TO DESIGN FOR ENGINEERING PURPOSES WITHOUT NOTICE. REVISIONS MAY NOT BE NOTED.

PAR-KUT INTERNATIONAL, INC.
 40961 Production Drive
 Harrison Twp, Mich.
 48049-1351
 PH. (586) 468-2947

DWG#	SEC-016	SHEET	A-1
PAR-KUT ENTRANCE BOOTH			
PO#	BASED ON #08-111		
SCALE	NTS	DRAWN BY	REVISD
DATE	4-7-2008	SIZE	6' X 8'
CHK'D BY:		SALES REPRESENTATIVE	