

NOTE: DESIGN LOADS; REFERENCE, MICHIGAN TESTING ENGINEERS APRIL 14, 1977. WHEN PAR-KUT BOOTH IS PROPERLY ANCHORED, IT MEETS OR EXCEEDS THE FOLLOWING DESIGN LOADS: 50 P.S.F. LIVE LOAD, 30 P.S.F. WIND LOAD.

1. COUNTER (OPTIONAL REAR)
2. DRAWER UNDER COUNTER.
3. DDDR- 28" WIDE, SLIDING ALUMINUM WITH WEATHER-STRIPPING, BALL BEARING HANGERS, SAFETY GLAZING, HEAVY DUTY TRACK, LOCK, & HARDWARE, 2ND DOOR OPTIONAL.
4. ELECTRICAL OUTLET 1-REQ'D. ADDITIONAL OUTLETS OPTIONAL.
5. SWITCH FOR INTERIOR LIGHTS #8.
6. OPTIONAL SWITCH FOR EXTERIOR LIGHTS.
7. OPTIONAL SWITCH FOR INTERIOR LIGHTS #9.
8. INTERIOR LIGHT. REAR LIGHT OPTIONAL.
9. OPTIONAL INTERIOR LIGHTS.
10. OPTIONAL EXTERIOR LIGHTS.
11. FAN FORCED HEATER.
12. OPTIONAL ROOF AIR CONDITIONER.
13. CIRCUIT BREAKER PANEL.
14. ANCHOR CLIP- 2" X 2" STEEL WELDED TO BASE AT GRADE WITH 3/4" ANCHOR BOLT HOLE. 4-REQ'D. ANCHOR BOOTH AFTER FINAL LOCATION. ANCHOR BOLTS NOT INCLUDED.

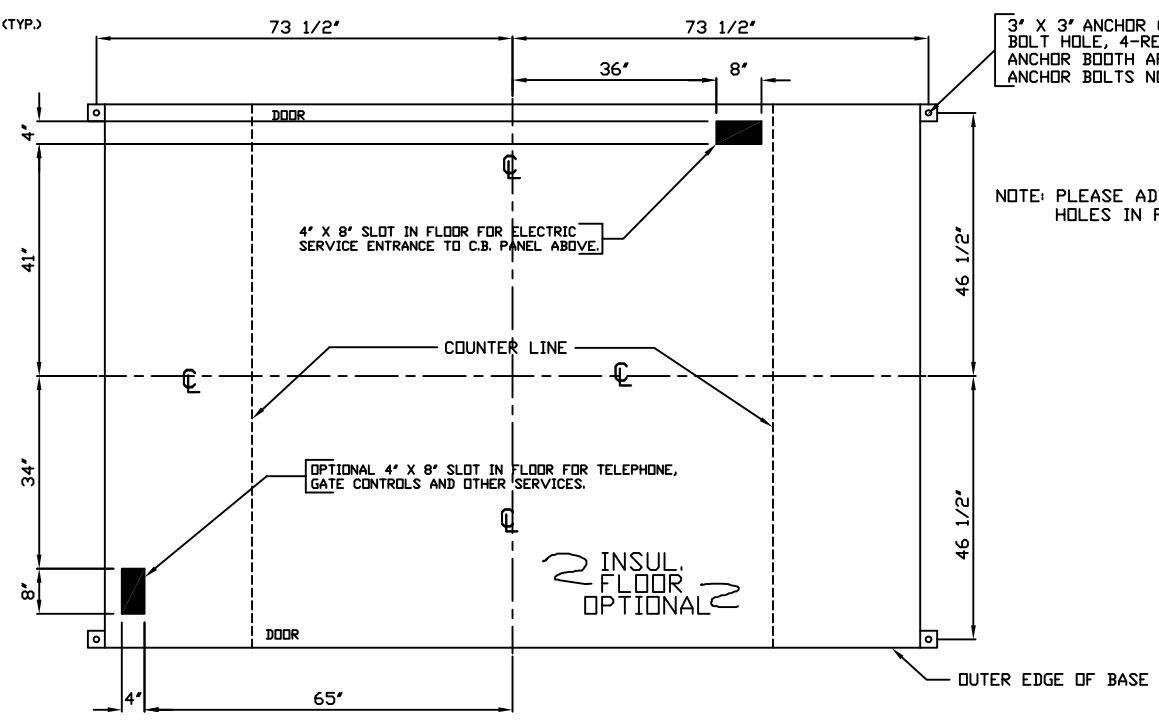
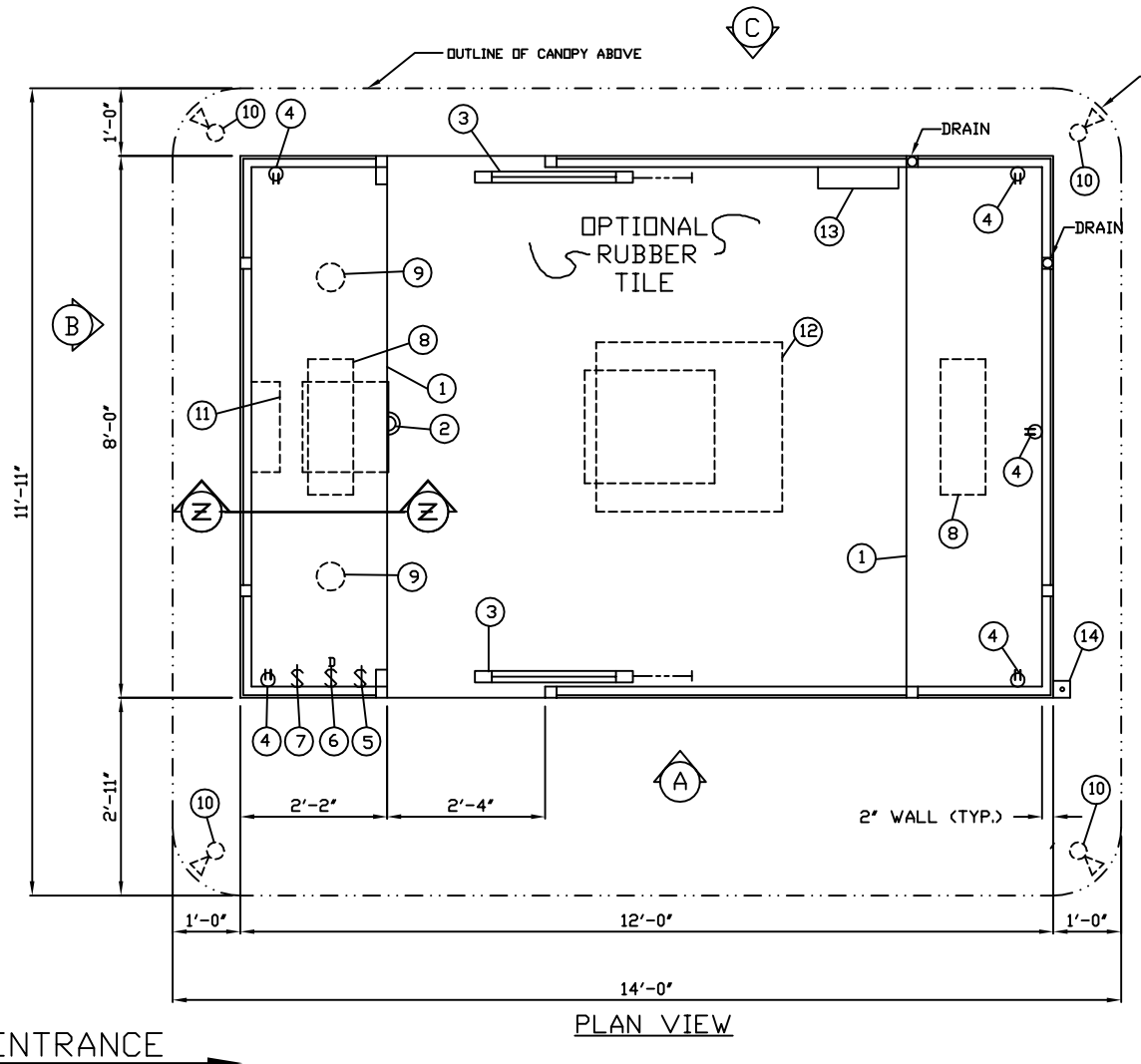

NOTE: PLEASE ADVISE IF PAR-KUT TO CUT ANY ADDITIONAL HOLES IN FLOOR FOR OTHER SERVICES.

NOTE: THIS PRINT AND DESIGN ARE THE PROPERTY OF PAR-KUT INTERNATIONAL, INC. IT MUST NOT BE REPRODUCED IN ANY MANNER, NOR SHALL IT BE SUBMITTED TO OUTSIDE PARTIES FOR EXAMINATION WITHOUT OUR CONSENT. IT SHALL BE USED ONLY AS A MEANS OF REFERENCE TO WORK DESIGNED AND FURNISHED BY PAR-KUT. PAR-KUT RESERVES THE RIGHT TO MAKE CHANGES TO DESIGN FOR ENGINEERING PURPOSES WITHOUT NOTICE. REVISIONS MAY NOT BE NOTED.

PAR-KUT INTERNATIONAL, INC.  
40961 Production Drive  
Harrison Twp, Mich.  
48045-1351  
PH. (810) 468-2947

DWG# STOPS SHEET A-1

#FRONTPAGE

A/E NOTES  
PAINT COLOR:

|                   |                       |                      |
|-------------------|-----------------------|----------------------|
| SCALE<br>NTS      | DRAWN BY<br>TEB / DLT | REVISED<br>11-7-2014 |
| DATE<br>4-12-2000 | SIZE<br>8' X 12'      | QTY                  |
| CHK'D BY:         | SALES REPRESENTATIVE  |                      |

ENTRANCE →