

- a. 2" X 2" X 1/4" MIN. ANCHOR CLIP WITH 3/4" ANCHOR BOLT HOLE, 6-REQ'D. ANCHOR BOOTH AFTER FINAL LOCATION. ANCHOR BOLTS NOT INCLUDED
- b. OUTER EDGE OF BASE
- c. LOCATION OF 1-3/4" DIAMETER HOLE FOR CUSTOMER POWER FEED TO JUNCTION BOX #3.

1. 6' PAINTED GALVANIZED STEEL BENCH WITH BACK REST, BENCH SEATS SUPPORTED WITH BRACKETS AND PAINTED, 2-REQ'D.
2. LITHONIA MODEL #2VRT-MT-3-32-VL-120-GEB RECESSED LIGHT WITH 1/2" CONDUIT RACEWAY TO JUNCTION BOX #3. FUTURE POWER SUPPLY AND SWITCHING PROVIDED ON SITE BY OTHERS. CONTROLLED BY SWITCH IN STARTER'S OFFICE.
3. 2" X 4" JUNCTION BOX MOUNTED FLUSH IN VERTICAL COLUMN BELOW BENCH 6" ABOVE GRADE FOR ELECTRICAL WIRE TERMINATION WITH REMOVABLE COVER FOR FUTURE CONDUIT INSTALLATION.

NOTE: PAR-KUT BOOTHS ARE OF SINGLE UNIT WELDED GALVANIZED STEEL CONSTRUCTION, FACTORY ASSEMBLED AND DELIVERED SET UP. FAILURE TO SECURELY ANCHOR BOOTH MAY RESULT IN OVERTURNING OF UNIT AND SERIOUS INJURY TO OCCUPANT.

- A. GLAZING TO BE 1/4" CLEAR TEMPERED SAFETY GLAZING WITH TAMPER PROOF SCREWS ON GLAZING STOPS SET IN ANODIZED ALUMINUM WINDOW FRAMES BEHIND 1" PAINTED STEEL MULLIONS.
- B. PAINT- A RUST INHIBITIVE PRIMER WITH AN INDUSTRIAL FINISH.
- C. ELECTRICAL- ALL WIRING BY PAR-KUT TO BE #12(MIN) STRANDED COPPER, THHN ENCLOSED IN 1/2"(MIN) E.M.T. PER NATIONAL ELECTRIC CODE. FITTINGS, FIXTURES, AND DEVICES ARE U.L. LABELED. ALL WIRING TO TERMINATE AT JUNCTION BOX.
- D. BOOTH WILL HAVE A 3" CANOPY OVERHANG AND A 6" FASCIA ON ALL SIDES.
- E. LIFTING RING(S) ARE PROVIDED IN ROOF.
- F. NO ON SITE WORK BY PAR-KUT.

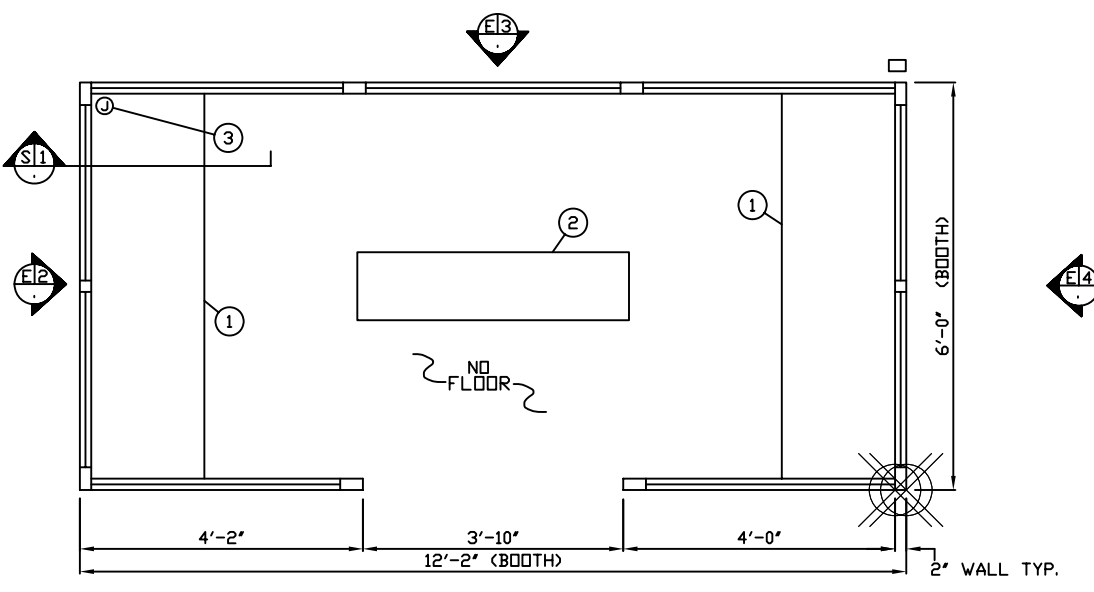

NOTE: THIS PRINT AND DESIGN ARE THE PROPERTY OF PAR-KUT INTERNATIONAL, INC. IT MUST NOT BE REPRODUCED IN ANY MANNER, NOR SHALL IT BE SUBMITTED TO OUTSIDE PARTIES FOR EXAMINATION WITHOUT OUR CONSENT. IT SHALL BE USED ONLY AS A MEANS OF REFERENCE TO WORK DESIGNED AND FURNISHED BY PAR-KUT. PAR-KUT RESERVES THE RIGHT TO MAKE CHANGES TO DESIGN FOR ENGINEERING PURPOSES WITHOUT NOTICE. REVISIONS MAY NOT BE NOTED.

PAR-KUT INTERNATIONAL, INC.
40961 Production Drive
Harrison Twp, Mich.
48045-1551
PH. (586) 468-2947

DWG# SHLT-009 SHEET A-1

Code References:
Massachusetts State Building Code - 6th Edition
2002 National Electrical Code

GENERAL NOTES		
PAINT COLOR: MATCH BENJAMIN MOORE ESSEX GREEN (HISTORICAL COLLECTION)		
PRE FINISHED ROOF COLOR: AGED COPPER		
PO#	VERBAL	SCALE
DATE	SIZE	QTY
CHK'D BY:	SALES REPRESENTATIVE	

PO#	VERBAL	SCALE
DATE	SIZE	QTY
CHK'D BY:	SALES REPRESENTATIVE	

E1 PLAN VIEW

TAMPER PROOF SCREWS ON GLAZING STOPS