

1. DOOR- OPTIONAL 40" WIDE SLIDING ALUMINUM 1-REQ'D, SECOND OPTIONAL.
2. LIGHT- OPTIONAL 2-40W LAMP FLUORESCENT FIXTURE WITH OPTIONAL VANDAL PROOF LENS 1-REQ'D, SECOND LIGHT OPTIONAL.
3. OPTIONAL KEY OPERATED LIGHT SWITCH.
4. CIRCUIT BREAKER PANEL- OPTIONAL RAIN PROOF, MAIN BREAKER IS INCLUDED.
5. HEATER- 120V./1500W. WITH OPTIONAL TAMPERPROOF COVER SECOND OPTIONAL.
6. 2" X 2" ANCHOR CLIP WITH 3/4" ANCHOR BOLT HOLE, 4-REQ'D, ONE IN EACH CORNER. ANCHOR BOLTS NOT INCLUDED.
7. OPTIONAL TIMER/ PUSH-BUTTON FOR HEATERS
8. OPTIONAL PHOTOELECTRIC CONTROLLER 3-WAY FOR LIGHTS
9. OPTIONAL BARREL BOLT INTO FLOOR GUIDE TO HOLD DOORS IN OPEN POSITION

NOTE: PAR-KUT BOOTHS ARE OF SINGLE UNIT WELDED GALVANIZED STEEL CONSTRUCTION. FACTORY ASSEMBLED AND DELIVERED SET UP. BOOTHS ARE GLAZED, INSULATED, WIRED, AND FINISH PAINTED COLOR OF CHOICE. (FROM PAR-KUT STANDARDS)

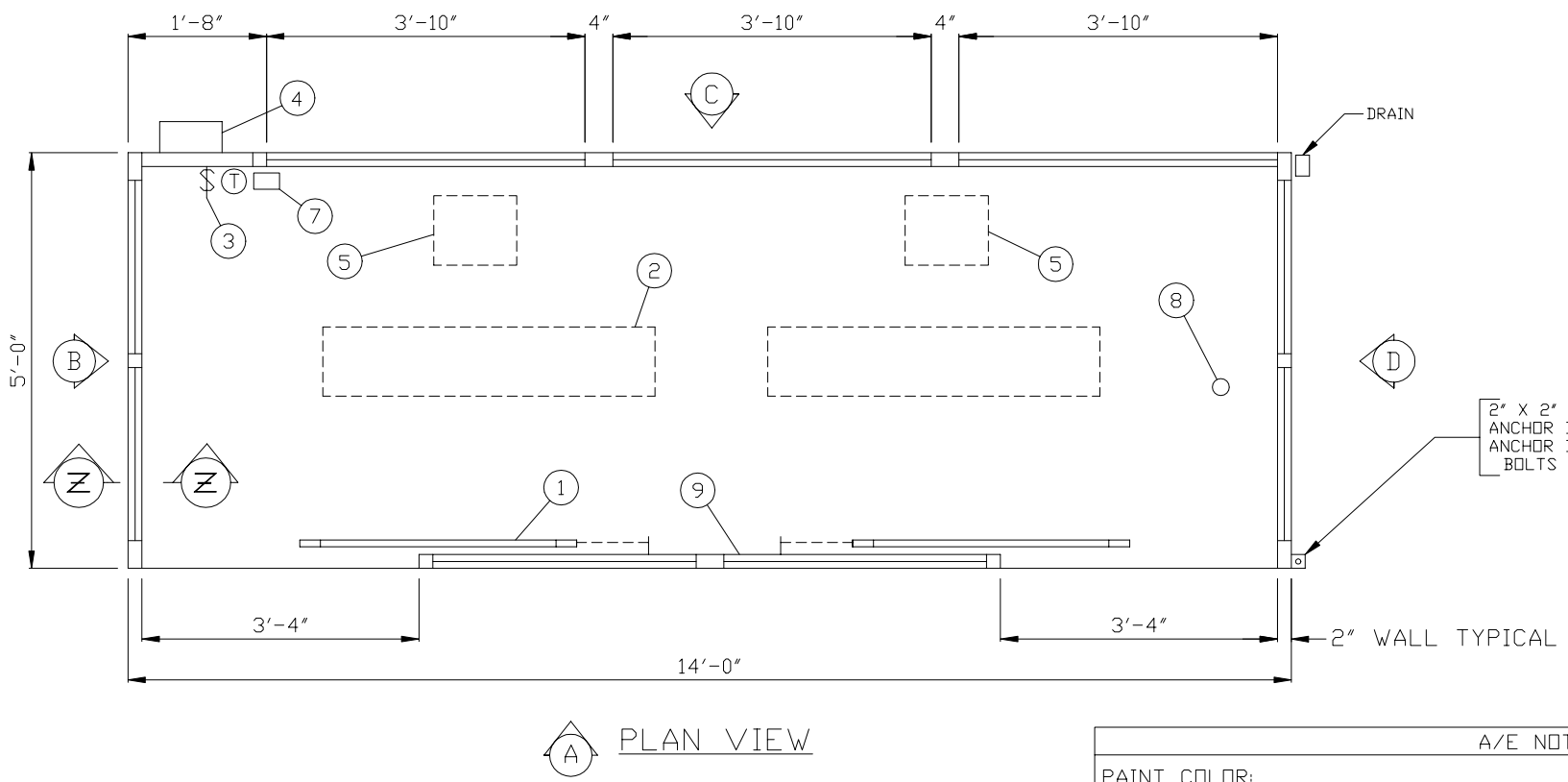
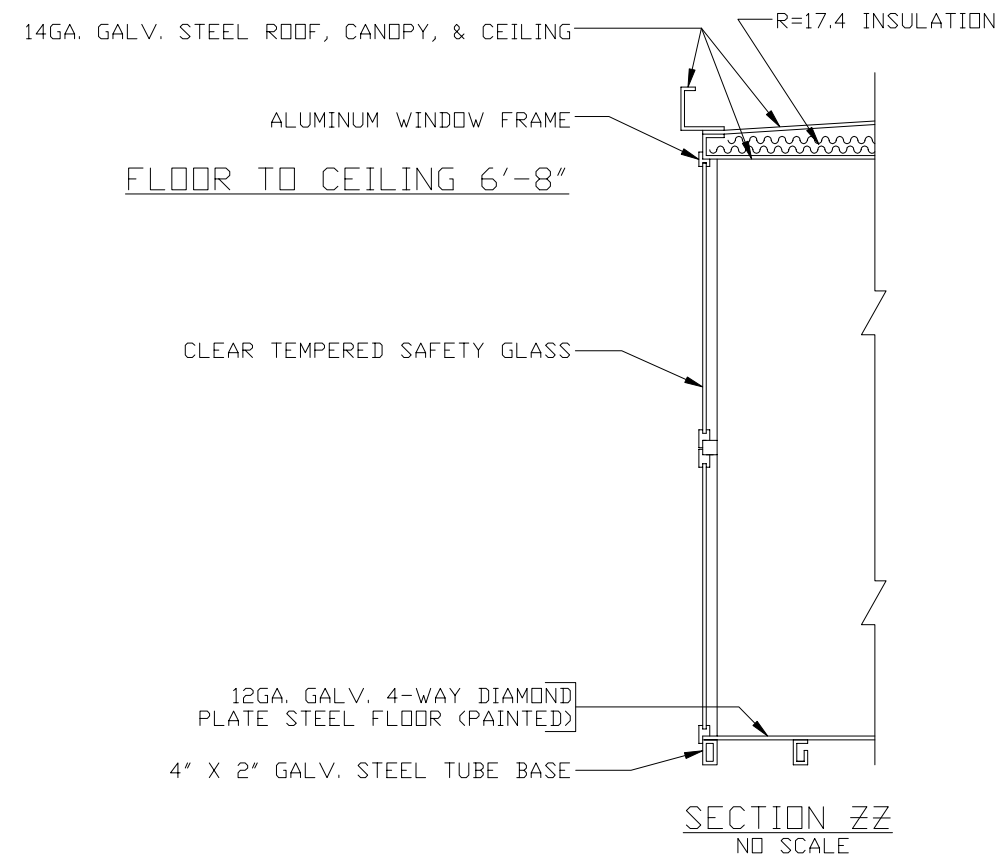

2" X 2" ANCHOR CLIP WELDED TO BASE WITH 3/4" ANCHOR BOLT HOLE, 4-REQ'D, ONE EACH CORNER. ANCHOR BOOTH AFTER FINAL LOCATION. ANCHOR BOLTS NOT INCLUDED.

NOTE: THIS PRINT AND DESIGN ARE THE PROPERTY OF PAR-KUT INTERNATIONAL, INC. IT MUST NOT BE REPRODUCED IN ANY MANNER, NOR SHALL IT BE SUBMITTED TO OUTSIDE PARTIES FOR EXAMINATION WITHOUT OUR CONSENT. IT SHALL BE USED ONLY AS A MEANS OF REFERENCE TO WORK DESIGNED AND FURNISHED BY PAR-KUT. PAR-KUT RESERVES THE RIGHT TO MAKE CHANGES TO DESIGN FOR ENGINEERING PURPOSES WITHOUT NOTICE. REVISIONS MAY NOT BE NOTED!

PAR-KUT INTERNATIONAL, INC.
 40961 PRODUCTION DRIVE
 HARRISON TOWNSHIP, MI. 48045-1351
 AREA CODE: (810) 468-2947

NO. 0121		
#145-BS		
SCALE	DRAWN BY	REVISED
NTS	DFS /DLT	
DATE	SIZE	QTY.
7-25-2000	5' X 14'	

A/E NOTES

PAINT COLOR: _____