

E1 ELEVATION

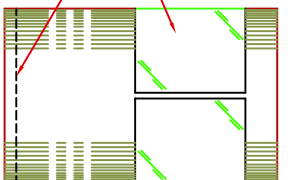

E2 ELEVATION

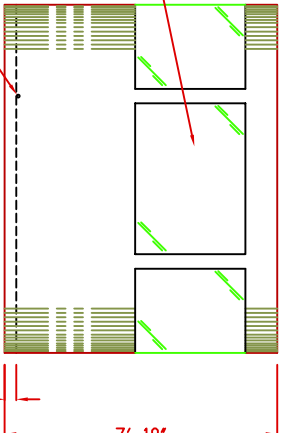

E3 ELEVATION

1. COUNTER- 28" DEEP PAINTED GALVANIZED STEEL MOUNTED 32" ABOVE FLOOR.
2. PAINTED STORAGE DRAWER BENEATH COUNTER.
3. DOOR- 30" WIDE, SLIDING STEEL WITH WEATHER-STRIPPING, BALL BEARING HANGERS, HEAVY DUTY TRACK, SAFETY GLAZING, HOOK BOLT LOCK, AND HARDWARE.
4. DUPLEX OUTLET MOUNTED ABOVE COUNTER.
5. RECESSED LAMP FLUORESCENT LIGHT FIXTURE WITH LENS.
6. SWITCH FOR INTERIOR LIGHT.
7. HEATER- WALL MOUNTED WITH INTEGRAL THERMOSTAT CONTROL.
8. C.B. PANEL- 12 SPACE, 120/240V, 1Ø-3 WIRE WITH GROUND, 100 AMP MAIN BREAKER INCLUDED.
9. 2" X 2" X 1/4"(MIN) STEEL ANCHOR CLIP WITH 3/4" ANCHOR BOLT HOLE, 4-REQ'D, WELDED TO BASE AT GRADE. ANCHOR BOLT AFTER FINAL LOCATION, ANCHOR BOLTS NOT INCLUDED.

NOTE: PAR-KUT BOOTHS ARE OF SINGLE UNIT WELDED STEEL CONSTRUCTION, FACTORY ASSEMBLED AND DELIVERED SET UP. FAILURE TO SECURELY ANCHOR BOOTH MAY RESULT IN OVERTURNING OF UNIT AND SERIOUS INJURY TO OCCUPANT.

- A. GLAZING- 3/16" POLYCARBONATE SAFETY GLAZING SET IN PAINTED STEEL EXTERIOR WINDOW FRAMES WITH ANODIZED ALUMINUM INTERIOR GLAZING STOPS IN CURVED ENDS ONLY. 1/4" TEMPERED SAFETY GLAZING SET IN PAINTED STEEL EXTERIOR WINDOW FRAMES WITH ANODIZED ALUMINUM INTERIOR GLAZING STOPS IN FLAT SIDES ONLY.
- B. PAINT- A RUST INHIBITIVE PRIMER WITH AN INDUSTRIAL FINISH.
- C. ELECTRICAL- ALL WIRING BY PAR-KUT TO BE #12(MIN) STRANDED COPPER, THHN ENCLOSED IN 1/2"(MIN) E.M.T. PER NATIONAL ELECTRIC CODE. FITTINGS, FIXTURES, AND DEVICES ARE UL, LABELED. ALL WIRING TO TERMINATE AT C.B. PANEL. ALL CIRCUITS HAVE GREEN GROUND WIRE.
- D. BOOTH WILL HAVE NO CANOPY OVERHANG ON ANY SIDE.
- E. LIFTING RINGS(S) ARE PROVIDED ON ROOF.
- F. NO ON SITE WORK BY PAR-KUT.

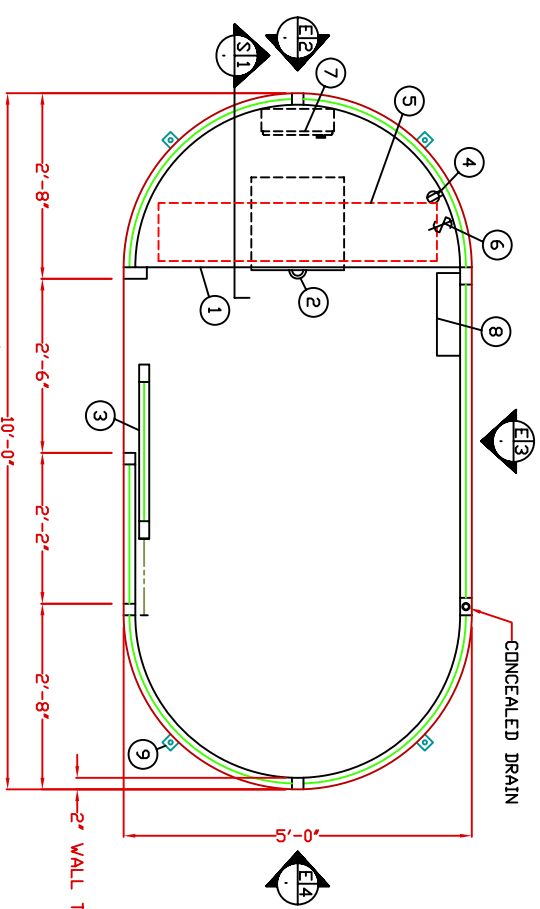

PLAN VIEW

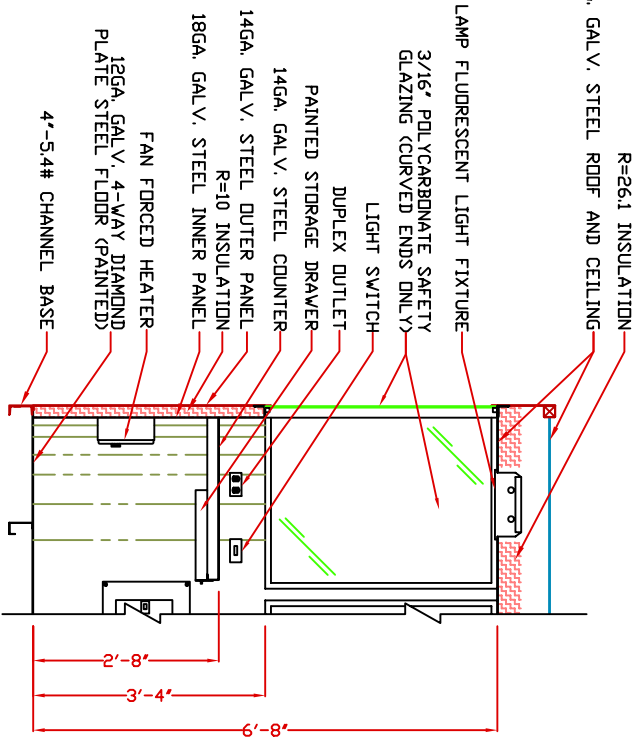

SECTION AND SCALE

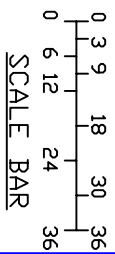

SCALE BAR

NOTE: THIS PRINT AND DESIGN ARE THE PROPERTY OF PAR-KUT INTERNATIONAL, INC. AND MUST NOT BE REPRODUCED OR TRANSMITTED IN ANY FORM OR BY ANY MEANS, ELECTRONIC OR MECHANICAL, INCLUDING PHOTOCOPYING, RECORDING, OR BY ANY INFORMATION STORAGE AND RETRIEVAL SYSTEM, WITHOUT THE WRITTEN PERMISSION OF PAR-KUT INTERNATIONAL, INC. PAR-KUT INTERNATIONAL, INC. 40961 Production Drive Harrison Twp, Mich. 48045-1551 Ph. (586) 468-2947

PAR-KUT INTERNATIONAL, INC.
40961 Production Drive
Harrison Twp, Mich.
48045-1551
Ph. (586) 468-2947

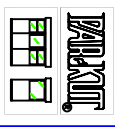

DWG# PK105CRV SHEET A-1

STANDARD 5' X 10' CURVE BOOTH
MODEL 105CRV

GENERAL NOTES
PAINT COLOR (PLEASE SPECIFY COLOR)

DATE	8-2-2002	SCALE	NTS	DRAWN BY	DLT	REVISED	4-27-2007
CHK'D BY:		SIZE	5' X 10'	SALES REPRESENTATIVE		QTY	